

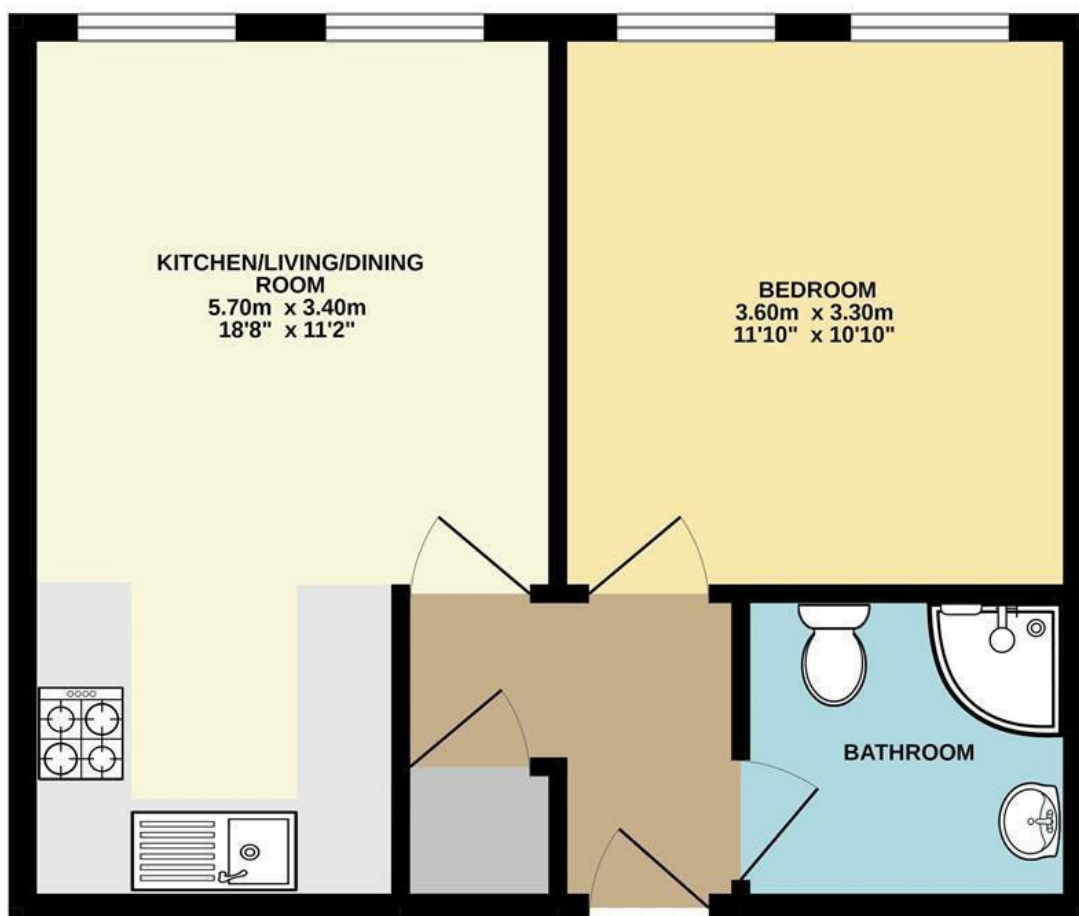

Surrey Street | Norwich | NR1  
 Guide £160,000

abbotFox



Energy Efficiency Rating		
	Current	Potential
Very energy efficient - lower running costs		
(92 plus) <b>A</b>		
(81-91) <b>B</b>		
(69-80) <b>C</b>		
(55-68) <b>D</b>		
(39-54) <b>E</b>		
(21-38) <b>F</b>		
(1-20) <b>G</b>		
Not energy efficient - higher running costs		
<b>England &amp; Wales</b>	EU Directive 2002/91/EC	

Disclaimer – In accordance with the Property Misdescriptions Act, the company gives notice that all descriptions, references to condition, necessary permissions for use and other details are given in good faith and believed to be correct, but any intending lessees do not rely on them as statements of fact, but must satisfy themselves by inspection or other means, as to their accuracy.

TOTAL FLOOR AREA : 37.5 sq.m. (404 sq.ft.) approx.  
 Whilst every attempt has been made to ensure the accuracy of the floorplan contained here, measurements of doors, windows, rooms and any other items are approximate and no responsibility is taken for any error, omission or mis-statement. This plan is for illustrative purposes only and should be used as such by any prospective purchaser. The services, systems and appliances shown have not been tested and no guarantee as to their operability or efficiency can be given.  
 Made with Metropix ©2022.



abbotFox presents this spacious one bedroom second floor apartment in the popular Sentinel House development on Surrey Street in Norwich's city centre.

Well laid out accommodation comprises, an entrance hall, open plan kitchen living room, double bedroom and a modern shower room.

Benefits include, a secure sentry system, silent internal ventilation, appliances included, a concierge service, resident's lounge, resident's gym. Parking spaces available to rent.

An ideal first purchase or buy to let. The rental value being £950 pcm.

